

FL_STAGED STREET TREE SET

PROJECT: BRIDGEFIELD-STAGE 7
CLIENT: GOLDFIELDS
ISSUE: F-FOR COUNCIL ENDORSEMENT

DRAWING SCHEDULE:

DRAWING NO.	DRAWING TITLE	ISSUE
SST00	COVER PAGE	F-FOR COUNCIL ENDORSEMENT
SST01	STREET TREE PLAN	F
SST02	LANDSCAPE DETAILS	F



CITY OF MELTON
 ENGINEERING PLANS
 (LANDSCAPE)
APPROVED
E. Wright 17/9/2019
 CITY DESIGN DATE

OVERALL PLAN
 NOT TO SCALE

APPROVED:

DATE:

DRAWING NOTES:

ISSUE	DATE	DESCRIPTION	INITIALS
C	07.11.18	FOR COUNCIL SUBMISSION	MG
D	12.12.18	FOR COUNCIL APPROVAL	KML
E	19.03.19	FOR COUNCIL ENDORSEMENT	KML
F	18.07.19	A/MENTS-COUNCIL COMMENTS	AP

PROJECT:
 BRIDGEFIELD-STAGE 7

DRAWING NO.:
 SST00

SCALE:
 NTS

DRAWING TITLE:
 COVER PAGE

ISSUE:
 F-FOR COUNCIL ENDORSEMENT

DRAWN BY: KML
CHECKED BY: AP

CLIENT:
 GOLDFIELDS
 BUILDING 5, 658 CHURCH STREET
 RICHMOND VIC 3121

DRAFT
 NOT FOR CONSTRUCTION

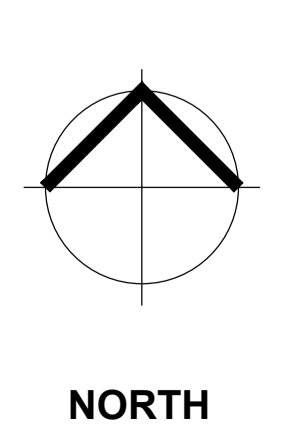

Fleming's Landscapes Pty Ltd
 PO BOX 21,
 MONBULK VIC 3783
 AUSTRALIA

P: (03) 9756 6105
 www.flemingslandscapes.com.au



MASTER PLANT SCHEDULE

TREES	CODE	BOTANICAL NAME	COMMON NAME	INSTALL HEIGHT	SIZE	CALIPER	QTY
	ULM par	ULMUS Parvifolia 'Todd'	Chinese Elm	2400mm	45L	30mm	23
	PYR cal	PYRUS Calleryana 'Chanticleer'	Chanticleer Pear	2400mm	45L	30mm	28
	COR mac	CORYMBIA Maculata	Spotted Gum	2400mm	45L	30mm	11
	AGO fle	AGONIS Flexuosa 'Burgandy'	Willow Myrtle	2400mm	45L	30mm	6
	ZEL ser	ZELKOVA Serrata 'Green Vase'	Japanese Elm	2400mm	45L	30mm	32

NOTE: Installation height and caliper quoted are consistent with cultivars specified. We welcome further discussion on AS and the interpretation of it

LEGEND-STREET TREES

- GRASS SEEDING
APPROX. 4408 SQ.M
AS PER NATURE STRIP GRASSING MIX
- REFER TO BELOW NOTES
- SEEDED NATIVE GRASSES
INDIGENOUS GRASS SPECIES MUST
BE LOCAL PROVENANCE FROM
SIMILAR SOIL TYPE AND FROM WITHIN
400-500mm ANNUAL RAINFALL AREA.
APPROX. 1647 SQ.M
AS PER NATURE NATIVE GRASSES MIX
- REFER TO BELOW NOTES
- STAGE BOUNDARY
- NO BOLLARDS

- NOTES:**
- NATURE STRIP GRASSING MIX SHALL BE:
 - KIKUYU 70%
 - RYE 15%
 - TALL FESCUE 15%
 - NATIVE NATURE STRIP GRASSES MIX SHALL BE:
 - MICROLAENA STIPIOIDES 69%
 - CHLORIS TRUNCATA 28%
 - AUSTRODANTHONIA GENICULATA 3%
 - TREES SHALL NOT BE PLANTED LESS THAN THE FOLLOWING DISTANCES FROM EXISTING ELEMENTS UNLESS OTHERWISE STATED IN THE DOCUMENTATION:

FOOTPATHS:	1.25M
DRIVEWAYS AND CROSSOVERS:	3.0M
STORMWATER AND SEWERAGE PITS:	2.0M
SERVICE CROSSINGS:	2.0M
INTERSECTIONS:	10.0M
KERB AND CHANNEL:	1.25M
STREET LIGHTS:	2.5M
FIRE PLUGS:	3.0M
ADJOINING PROPERTIES AND COUNCIL BUILDINGS:	5.0M (SMALL TREE ONLY)
 - LV CONNECTIONS (orange colour) 3.0M
HV CONNECTIONS (orange colour) 5.0M
CONDUITS (orange colour)
 - TREE LOCATIONS ARE TO BE CONFIRMED ON SITE BY COUNCIL PRIOR TO EXCAVATION AND INSTALLATION

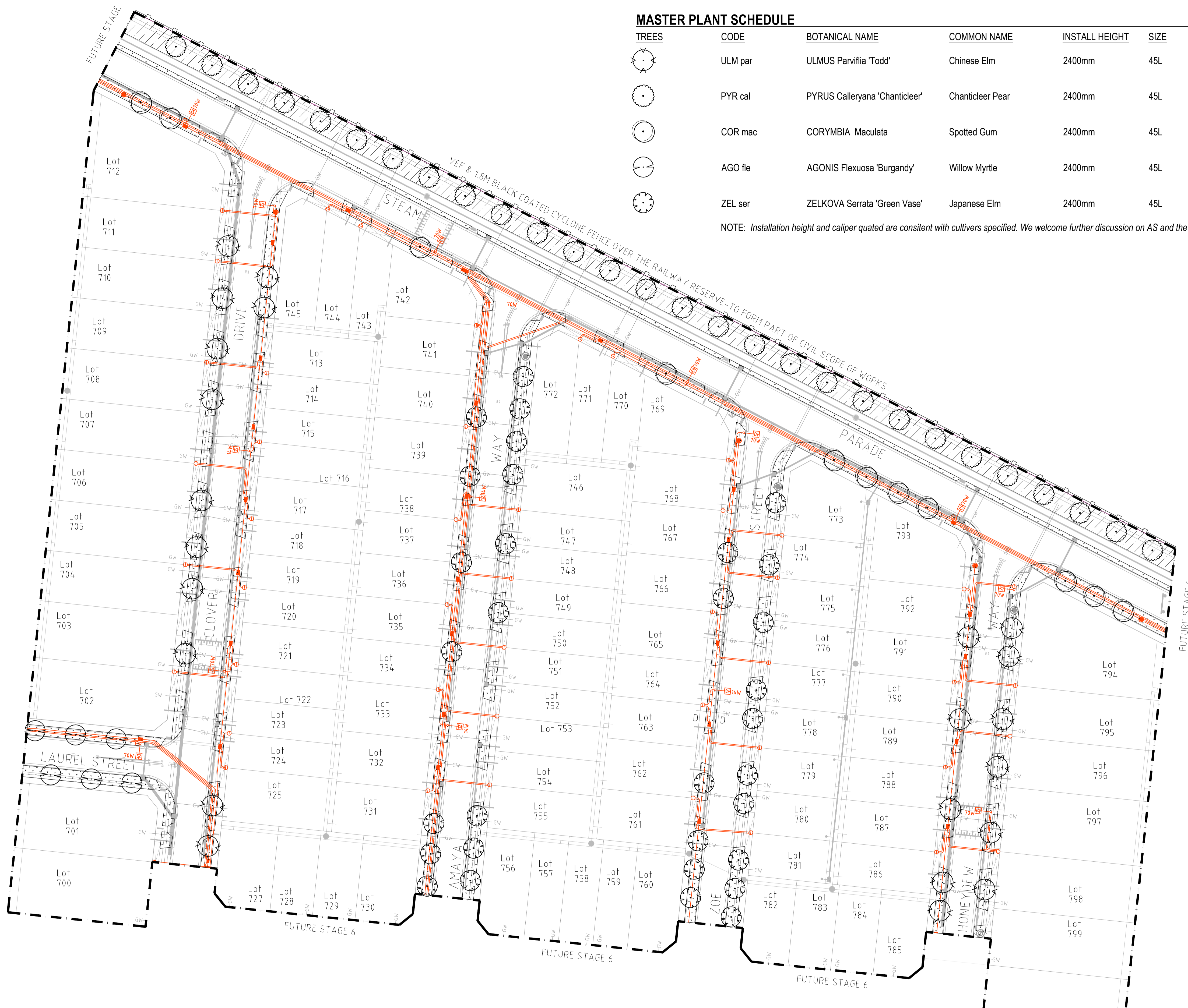

CITY OF MELTON
ENGINEERING PLANS
(LANDSCAPE)
APPROVED
E. Wright 17/9/2019
CITY DESIGN DATE

APPROVED:

DATE:

DRAWING NOTES:

ISSUE	DATE	DESCRIPTION	INITIALS
C	07.11.18	FOR COUNCIL SUBMISSION	MG
D	12.12.18	FOR COUNCIL APPROVAL	KML
E	19.03.19	FOR COUNCIL ENDORSEMENT	KML
F	18.07.19	AMENTS-COUNCIL COMMENTS	AP

PROJECT:
BRIDGEFIELD-STAGE 7

DRAWING NO.:
SST01

SCALE:
1:500@A1 / 1:1000@A1

DRAWING TITLE:
STREET TREE PLAN

ISSUE:
F

DRAWN BY:
KML

CHECKED BY:
AP

CLIENT:
GOLDFIELDS
BUILDING 5, 658 CHURCH STREET
RICHMOND VIC 3121

DRAFT
NOT FOR CONSTRUCTION

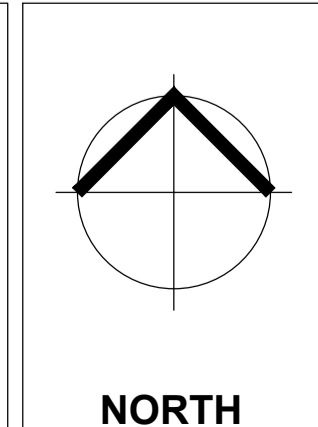

Fleming's Landscapes Pty Ltd
PO BOX 21,
MONBULK VIC 3783
AUSTRALIA

P: (03) 9756 6105
www.flemingslandscapes.com.au



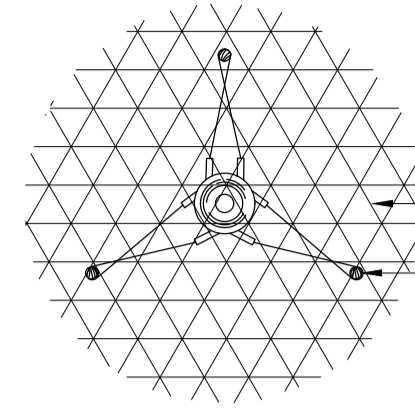

MULCH PROTECTION RING TO EACH ENTRY SPECIMEN
 TREE TO BE SECURED TO EACH STAKE WITH 3X NO. 50MM WIDE HESSIAN OR NYLON TIES WRAPPED AROUND THE TRUNK AND SECURED BACK TO STAKE WITH STAPLES OR NAILS ALLOWING SOME TRUNK MOVEMENT

TO PROMOTE LATERAL ROOT GROWTH THE PLANTING HOLE SHOULD BE NO LESS THAN 2 TIMES THE DIAMETER OF THE ROOT BALL



NOTES:

- TREES SHALL HAVE A WELL-DEVELOPED TAPER AND BE SELF-SUPPORTING IN BOTH BALL AND TRUNK
- EACH TREE MUST DEMONSTRATE A SINGLE CENTRAL LEADER WITH GOOD BRANCH STRUCTURE THROUGHOUT
- ALL TREES SHALL BE OF GOOD HEALTH AND VIGOR WITH NO PEST OR DISEASE PRESENT
- TREES SHALL SHOW NO SIGNS OF STRESS OR DAMAGE
- WATER IMMEDIATELY FOLLOWING PLANTING

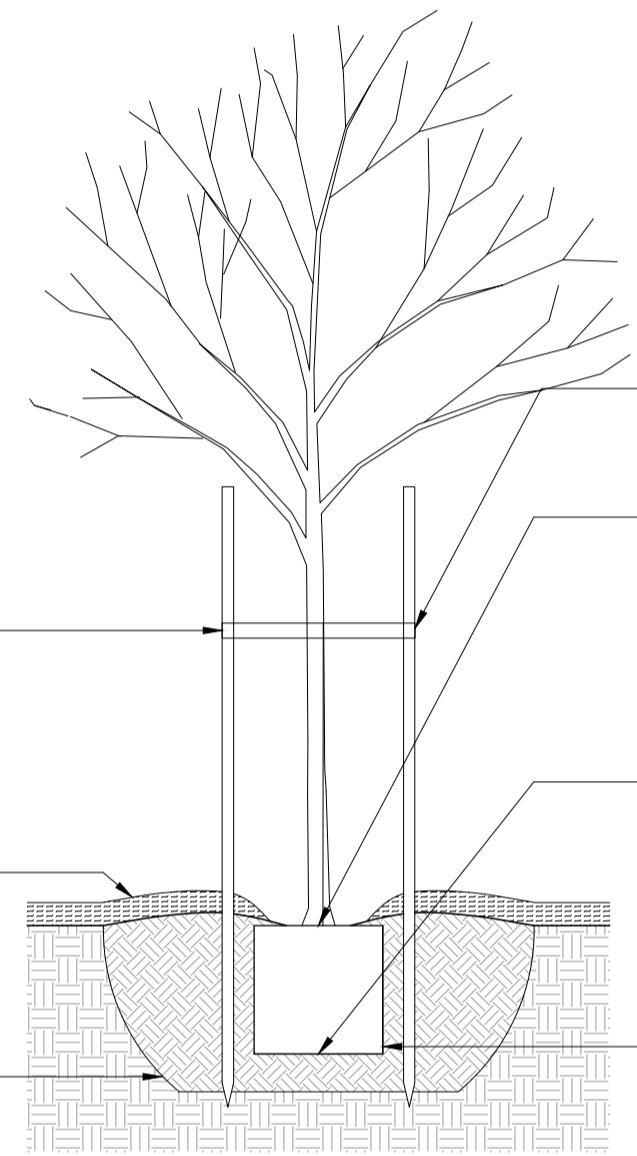

50MM WIDE NYLON OR HESSIAN TIES FIXED AT STAKE, PLACED 300MM SPACING, NO GREATER THAN 1/2 TREE HEIGHT. TIES ARE TO BE LOOSE FIT AND ALLOW FOR SAFE MOVEMENT OF TREE CANOPY

MULCH AS SPECIFIED TO A MIN. DEPTH OF 150MM FROM EDGE OF THE ROOT BALL TO THE EDGE OF THE PLANTING PIT. KEEP MULCH AWAY FROM STEM AND DO NOT COVER ROOTBALL

BREAK UP SIDES AND BASE OF EXCAVATION TO 100MM

TREE STAKES TO BE SET VERTICALLY AND CLEAR OF ROOT BALL. STAKE TO BE 50MMX50MMX2.4M DRIVEN A MIN OF 800MM INTO GROUND

PLACE PLANT IN CENTRE OF HOLE AT GROUND LEVEL WITH ROOT BALL RESTING ON THE BASE OF THE HOLE BACKFILL HOLE WITH APPROVED SITE SOIL. ROOTBALL TO BE PROPERLY PREPARED PRIOR TO PLANTING. ENSURE NO ROOTS ARE PROTRUDING ABOVE THE FINISHED SURFACE

PLACE PLANT IN CENTRE OF HOLE AT GROUND LEVEL WITH ROOT BALL RESTING ON THE BASE OF THE HOLE BACKFILL HOLE WITH APPROVED SITE SOIL. ROOTBALL TO BE PROPERLY PREPARED PRIOR TO PLANTING. ENSURE NO ROOTS ARE PROTRUDING ABOVE THE FINISHED SURFACE

EXCAVATE PLANTING HOLE WITH SLOPING SIDES 2XTIMES THE DIAMETER OF THE ROOT BALL. DEPTH OF PLANTING HOLE TO BE ONLY SLIGHTLY BELOW THE DEPTH OF THE ROOT BALL. BREAK UP SIDES AND BASE OF EXCAVATION TO 100MM. TOP OF ROOT BALL IS FLUSH WITH FINISHED LEVEL OF PLANTING HOLE

A TREE PLANTING DETAIL
002 1:50@A1

NOTES:

- TOPSOIL SHOULD BE FREE OF ROCK AND WEEDS
- NATURE STRIPS SHOULD BE AT 80% COVERAGE AND GERMINATION AT PC

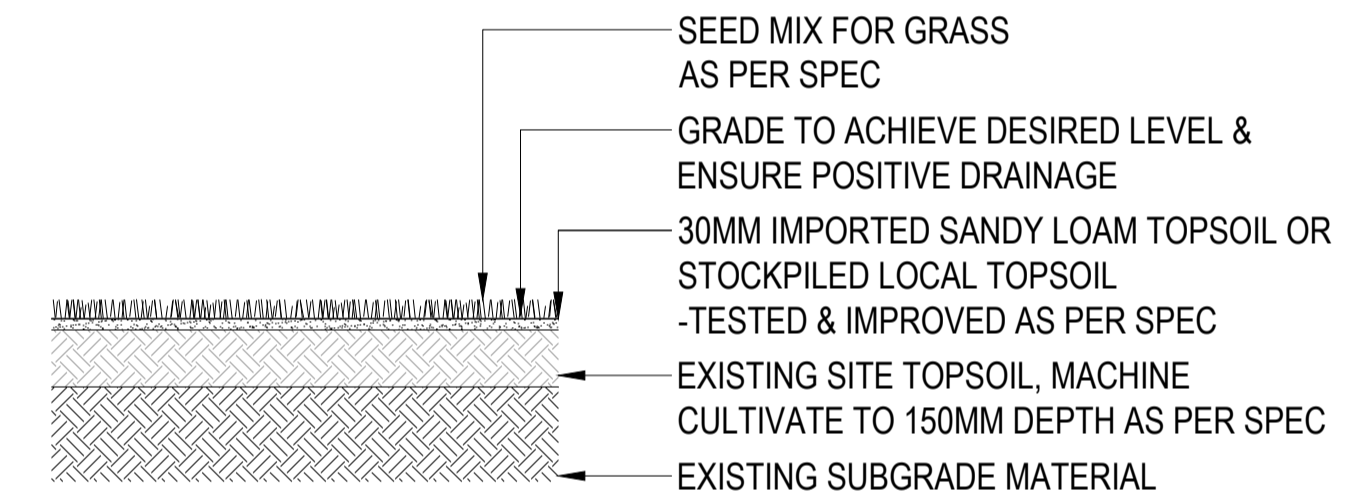

B GRASS SEEDING DETAIL
002 1:20@A1

CITY OF MELTON
 ENGINEERING PLANS
 (LANDSCAPE)
 APPROVED
 E. Wright 17/9/2019
 CITY DESIGN DATE

APPROVED:

DATE:

DRAWING NOTES:

ISSUE	DATE	DESCRIPTION	INITIALS
C	07.11.18	FOR COUNCIL SUBMISSION	MG
D	12.12.18	FOR COUNCIL APPROVAL	KML
E	19.03.19	FOR COUNCIL ENDORSEMENT	KML
F	18.07.19	A/MENTS-COUNCIL COMMENTS	AP

PROJECT:
 BRIDGEFIELD-STAGE 7

DRAWING NO.:
 SST02

SCALE:
 AS SHOWN

DRAWING TITLE:
 LANDSCAPE DETAILS

ISSUE:
 F

DRAWN BY: KML
CHECKED BY: AP

CLIENT:
 GOLDFIELDS
 BUILDING 5, 658 CHURCH STREET
 RICHMOND VIC 3121

DRAFT
 NOT FOR CONSTRUCTION

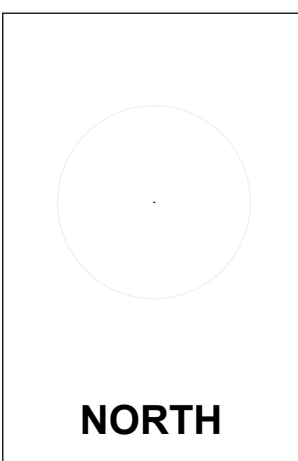

Fleming's Landscapes Pty Ltd
 PO BOX 21,
 MONBULK VIC 3783
 AUSTRALIA

P: (03) 9756 6105
 www.flemingslandscapes.com.au

