

# FL\_STAGED STREET TREE SET

**PROJECT:** BRIDGEFIELD-STAGE 5  
**CLIENT:** GOLDFIELDS  
**ISSUE:** F

**DRAWING SCHEDULE:**

DRAWING NO.	DRAWING TITLE	ISSUE
SST00	COVER PAGE	F
SST01	STREET TREE PLAN	F
SST02	LANDSCAPE DETAILS	F



**OVERALL PLAN**  
NOT TO SCALE

**CITY OF MELTON**  
ENGINEERING PLANS  
(LANDSCAPE)  
**APPROVED**  
20 Nov 2019  
CITY DESIGN DATE

**APPROVED:**  
---  
**DATE:**  
---

DRAWING NOTES:			
ISSUE	DATE	DESCRIPTION	INITIALS
C	12.12.18	FOR COUNCIL APPROVAL	KML
D	19.03.19	FOR COUNCIL ENDORSEMENT	KML
E	06.06.19	A/MENTS-ELEC&CIVIL UPDATES	KML
F	30.10.19	A/MENTS-COUNCIL COMMENTS	AP

**PROJECT:** BRIDGEFIELD-STAGE 5  
**DRAWING NO.:** SST00  
**SCALE:** NTS

**DRAWING TITLE:** COVER PAGE  
**ISSUE:** F  
**DRAWN BY:** AP  
**CHECKED BY:** LU

**CLIENT:** GOLDFIELDS  
 BUILDING 5, 658 CHURCH STREET  
 RICHMOND VIC 3121

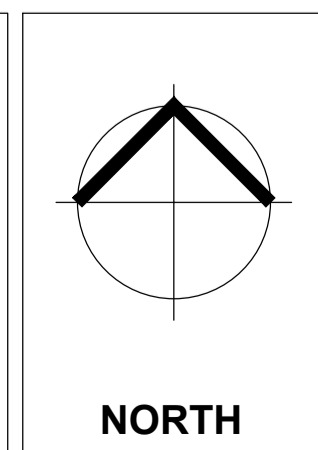

**FLOW DESIGN STUDIO**  
 112 CHESTNUTE STREET  
 CREMORNE VIC 3121  
 AUSTRALIA  
 P: (03) 9425 9395  
[www.flowdesignstudio.com.au](http://www.flowdesignstudio.com.au)



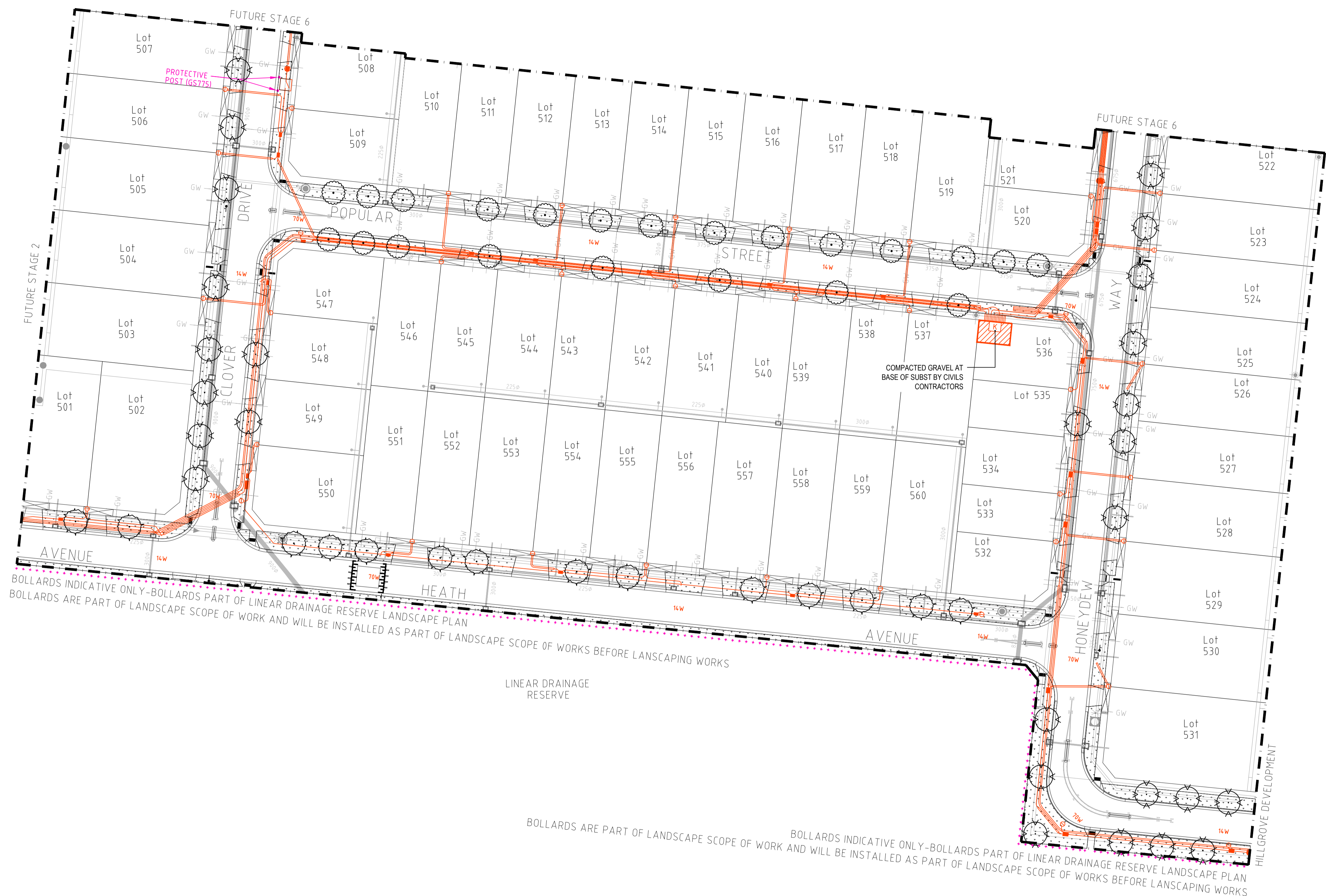

**LEGEND-STREET TREES**

GRASS SEEDING  
APPROX. 2753 SQ.M  
AS PER NATURE STRIP GRASSING MIX  
- REFER TO BELOW NOTES

STAGE BOUNDARY

PROTECTIVE BOLLARDS  
APPROX. 2 IN TOTAL  
- REFER TO DETAIL ON SST03

**NOTES:**

- NATURE STRIP GRASSING MIX SHALL BE:  
KIKUYU 70%  
RYE 15%  
TALL FESCUE 15%
- TREES SHALL NOT BE PLANTED LESS THAN THE FOLLOWING DISTANCES FROM EXISTING ELEMENTS UNLESS OTHERWISE STATED IN THE DOCUMENTATION:  
  

FOOTPATHS:	1.25M
DRIVEWAYS AND CROSSOVERS:	3.0M
STORMWATER AND SEWERAGE PITS:	2.0M
SERVICE CROSSINGS:	2.0M
INTERSECTIONS:	10.0M
KERB AND CHANNEL:	1.25M
STREET LIGHTS:	2.5M
FIRE PLUGS:	3.0M
ADJOINING PROPERTIES AND COUNCIL BUILDINGS:	5.0M (SMALL TREE ONLY)

LV CONNECTIONS (orange colour)	3.0M
HV CONNECTIONS (orange colour)	5.0M
CONDUITS (orange colour)	
- TREE LOCATIONS ARE TO BE CONFIRMED ON SITE BY COUNCIL PRIOR TO EXCAVATION AND INSTALLATION

**CITY OF MELTON**  
ENGINEERING PLANS  
(LANDSCAPE)  
**APPROVED**  
  
20 Nov 2019  
CITY DESIGN DATE

**MASTER PLANT SCHEDULE**

TREES	CODE	BOTANICAL NAME	COMMON NAME	INSTALL HEIGHT	SIZE	CALIPER	QTY
	ULM par	ULMUS Parvifolia 'Todd'	Chinese Elm	2400mm	45L	30mm	27
	PYR cal	PYRUS Calleryana 'Chanticleer'	Chanticleer Pear	2400mm	45L	30mm	22
	KOE pan	KOELREUTERIA Paniculata	Golden Rain Tree	2400mm	45L	30mm	14

NOTE: Installation height and caliper quoted are consistent with cultivars specified. We welcome further discussion on AS and the interpretation of it

**APPROVED:**  
---  
  
**DATE:**  
---

**DRAWING NOTES:**

ISSUE	DATE	DESCRIPTION	INITIALS
C	12.12.18	FOR COUNCIL APPROVAL	KML
D	19.03.19	FOR COUNCIL ENDORSEMENT	KML
E	06.06.19	A/MENTS-ELEC&CIVIL UPDATES	KML
F	30.10.19	A/MENTS-COUNCIL COMMENTS	AP

**PROJECT:**  
BRIDGEFIELD-STAGE 5

**DRAWING NO.:**  
SST01

**SCALE:**  
1:500@A1 / 1:1000@A1

**DRAWING TITLE:**  
STREET TREE PLAN

**ISSUE:**  
F

**DRAWN BY:**  
AP

**CHECKED BY:**  
LU

**CLIENT:**  
GOLDFIELDS  
BUILDING 5, 658 CHURCH STREET  
RICHMOND VIC 3121

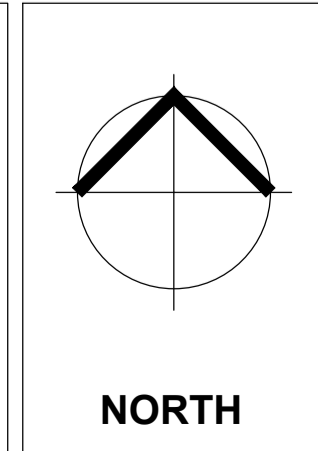

**FLOW DESIGN STUDIO**  
112 CHESTNUTE STREET  
CREMORNE VIC 3121  
AUSTRALIA  
  
P: (03) 9425 9395  
  
www.flowdesignstudio.com.au



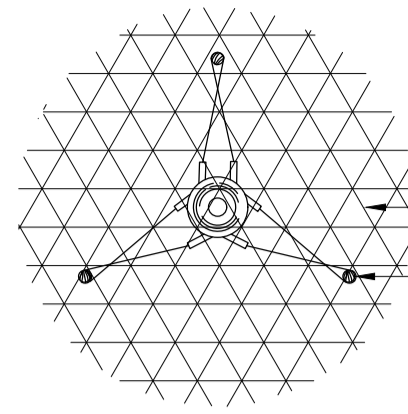

MULCH PROTECTION RING TO EACH ENTRY SPECIMEN  
TREE TO BE SECURED TO EACH STAKE WITH 3X NO. 50MM WIDE HESSIAN OR NYLON TIES WRAPPED AROUND THE TRUNK AND SECURED BACK TO STAKE WITH STAPLES OR NAILS ALLOWING SOME TRUNK MOVEMENT

TO PROMOTE LATERAL ROOT GROWTH THE PLANTING HOLE SHOULD BE NO LESS THAN 2 TIMES THE DIAMETER OF THE ROOT BALL

**NOTES:**

- TREES SHALL BE SELF SUPPORTING
- TREES SHALL BE OF GOOD HEALTH AND VIGOR
- ENSURE ALL LABELS WIRES, TWINE AND OTHER BINDING MATERIALS ARE REMOVED FROM PLANTING MATERIAL, INCLUDING ROOT BALLS PRIOR TO BACKFILLING
- WATER IMMEDIATELY FOLLOWING PLANTING, SAUCER TO BE FILLED TWICE
- SITE TO BE LEFT CLEAN AND TIDY ON COMPLETION OF PLANTING, REMOVE WEEDS AND BUILDING SPOIL FROM TREE PLANTING ZONE
- FOR TREES BETWEEN:
  - 1.5M-2.5M HIGH - SUPPLY STAKES AT 1.8M HEIGHT,
  - 2.5M-3.0M HIGH - SUPPLY STAKES AT 2.1M HEIGHT,
  - ABOVE 3.5M HIGH - SUPPLY STAKES AT 2.4M HEIGHT
- ANY VARIATIONS TO THIS DETAIL TO BE SUBMITTED FOR APPROVAL PRIOR TO ANY PLANTING
- MULCH SURROUND TO TREES IN GRASS AREA TO FINISH WITH NEAT SPADE CUT EDGE

50MM WIDE NYLON OR HESSIAN TIES FIXED AT STAKE, PLACED 300MM SPACING, NO GREATER THAN 1/2 TREE HEIGHT. TIES ARE TO BE LOOSE FIT AND ALLOW FOR SAFE MOVEMENT OF TREE CANOPY

MULCH AS SPECIFIED TO A MIN. DEPTH OF 150MM FROM EDGE OF THE ROOT BALL TO THE EDGE OF THE PLANTING PIT. KEEP MULCH AWAY FROM STEM AND DO NOT COVER ROOTBALL

BREAK UP SIDES AND BASE OF EXCAVATION TO 100MM

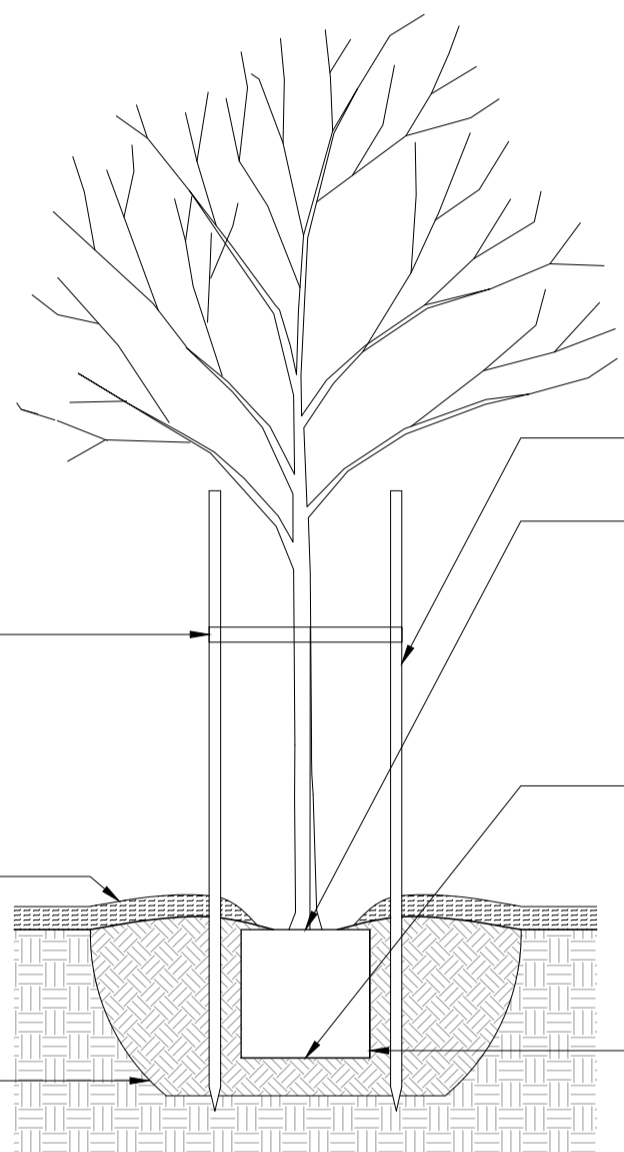

TREE STAKES TO BE SET VERTICALLY AND CLEAR OF ROOT BALL  
TOP OF ROOTBALL IS FLUSH WITH FINISHED LEVEL OF SITE SOIL. FORM A WATERING BASIN AROUND THE BASE OF THE PLANT ENSURING NO BUILD UP OF SOIL OR MULCH AROUND THE BASE OF THE TRUNK

PLACE PLANT IN CENTRE OF HOLE AT GROUND LEVEL WITH ROOT BALL RESTING ON THE BASE OF THE HOLE BACKFILL HOLE WITH APPROVED SITE SOIL. ROOTBALL TO BE PROPERLY PREPARED PRIOR TO PLANTING. ENSURE NO ROOTS ARE PROTRUDING ABOVE THE FINISHED SURFACE

EXCAVATE PLANTING HOLE WITH SLOPING SIDES 2XTIMES THE DIAMETER OF THE ROOT BALL. DEPTH OF PLANTING HOLE TO BE ONLY SLIGHTLY BELOW THE DEPTH OF THE ROOT BALL. BREAK UP SIDES AND BASE OF EXCAVATION TO 100MM. TOP OF ROOT BALL IS FLUSH WITH FINISHED LEVEL OF PLANTING HOLE

**A** TREE PLANTING DETAIL  
002 1:50@A1

**NOTES:**

- TOPSOIL SHOULD BE FREE OF ROCK AND WEEDS
- NATURE STRIPS SHOULD BE AT 80% COVERAGE AND GERMINATION AT PC

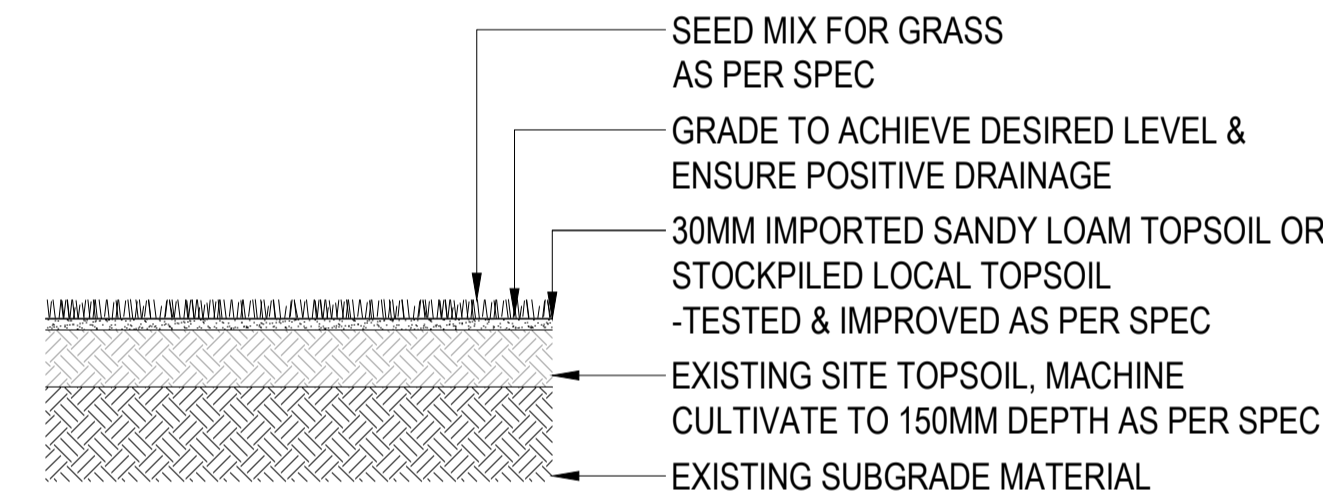

**B** GRASS SEEDING DETAIL  
002 1:20@A1

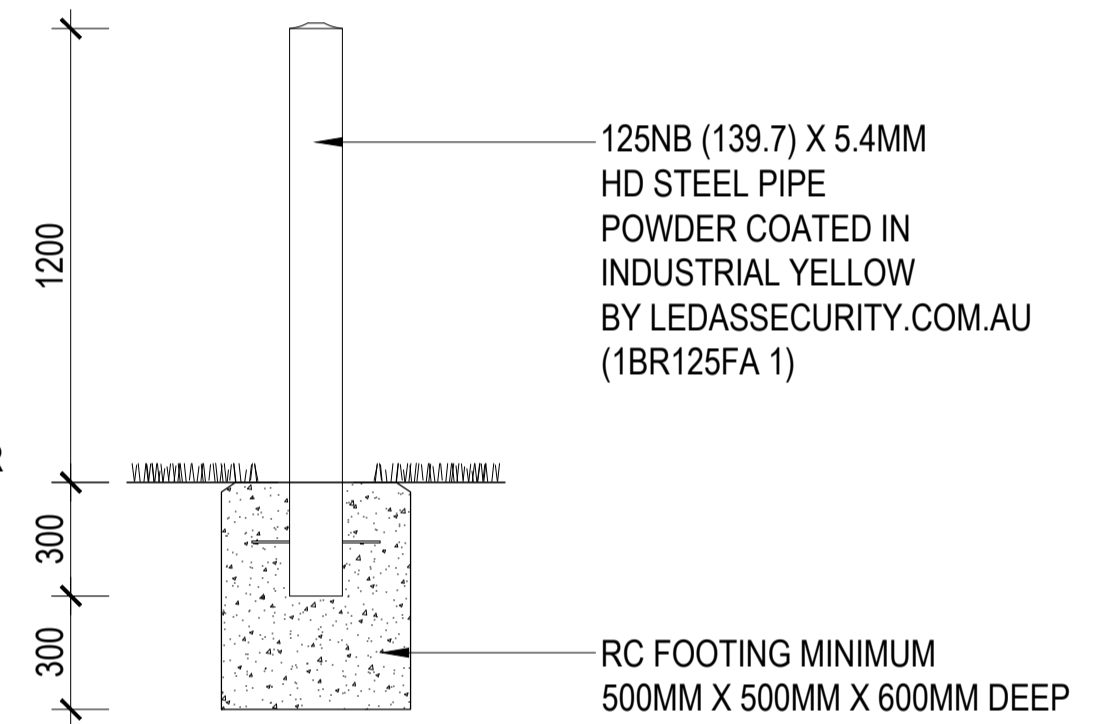

**C** FIXED BOLLARD DETAIL  
002 1:20@A1

**APPROVED:**  
---  
**DATE:**  
---

DRAWING NOTES:			
ISSUE	DATE	DESCRIPTION	INITIALS
C	12.12.18	FOR COUNCIL APPROVAL	KML
D	19.03.19	FOR COUNCIL ENDORSEMENT	KML
E	06.06.19	A/MENTS-ELEC&CIVIL UPDATES	KML
F	30.10.19	A/MENTS-COUNCIL COMMENTS	AP

**PROJECT:**  
BRIDGEFIELD-STAGE 5  
**DRAWING NO.:**  
SST02  
**SCALE:**  
AS SHOWN

**DRAWING TITLE:**  
LANDSCAPE DETAILS  
**ISSUE:**  
F  
**DRAWN BY:**  
AP  
**CHECKED BY:**  
LU

**CLIENT:**  
GOLDFIELDS  
BUILDING 5, 658 CHURCH STREET  
RICHMOND VIC 3121

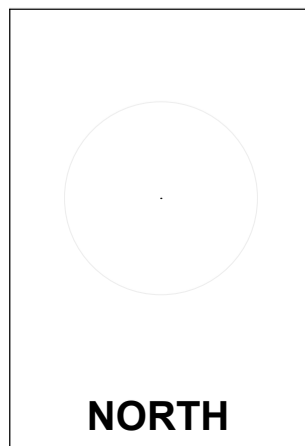

**FLOW DESIGN STUDIO**  
112 CHESTNUTE STREET  
CREMORNE VIC 3121  
AUSTRALIA  
P: (03) 9425 9395  
www.flowdesignstudio.com.au

