

**DISCLAIMER**  
 THE CONTENT ON THIS PLAN IS FOR PRELIMINARY PURPOSES ONLY AND IS SUBJECT TO THE FORMAL PLANNING APPROVAL BY CITY OF MELTON, DETAILED ENGINEERING DESIGN AND APPROVALS FROM CITY OF MELTON AND ALL SERVICE AUTHORITIES. AS SUCH THIS PLAN IS SUBJECT TO CHANGE WITHOUT NOTICE. THIS PLAN IS NOT TO BE USED FOR ANY PURPOSE OTHER THAN FOR PRELIMINARY PURPOSES. HOUSE SITING SHOULD ONLY BE COMPLETED ONCE COUNCIL APPROVED PLANS ARE ISSUED. THE DEVELOPER BEARS NO RESPONSIBILITY FOR ANY OF THESE CHANGES. THE PURCHASER SHOULD ASCERTAIN THE DETAILS ARE CORRECT BEFORE PROCEEDING.

**WARNING**  
 BEWARE OF UNDERGROUND SERVICES  
 THE LOCATIONS OF UNDERGROUND SERVICES ARE APPROXIMATE ONLY AND THEIR EXACT POSITION SHOULD BE PROVEN ON SITE. NO GUARANTEE IS GIVEN THAT ALL EXISTING SERVICES ARE SHOWN.

**LEGEND**  
 CUT EARTHWORKS - CUT AREA WITHIN LOTS GREATER THAN 50mm DEPTH  
 FILL EARTHWORKS - FILL AREA WITHIN LOTS GREATER THAN 50mm DEPTH  
 THIS PLAN SHOWS ONLY APPROXIMATE EXTENTS & LEVELS OF FILL TO BE PLACED DURING CONSTRUCTION. DEPTH OF FILL USED FOR TOP DRESSING SHALL ACCORDINGLY VARY BY UP TO 15mm. THE CONTRACTOR SHALL BE RESPONSIBLE FOR VERIFYING THE EXACT POSITION OF ALL SERVICES AND TO MAKE ANY NECESSARY CHANGE FOLLOWING FINAL INSPECTION BY GEOTECHNICAL ENGINEER.

**NOTES**  
 1. DESIGN LINE IS NOT IN CENTRE OF ROAD RESERVE. REFER TO CROSS SECTION FOR DETAILS.  
 2. REFER TO SHEET FOR TBM DATA.  
 3. DRAINAGE COORDINATES SHOWN REFER TO CENTRE OF PIT/TYPE.

**REFER TO INTERIM ROAD WIDENING PLANS FOR AS-CONSTRUCTED INFORMATION**

**AS CONSTRUCTED**

THIS DRAWING IS NOT TO BE COPIED OR SCALED

VERSION	REMARKS	DATE	BY
K	AS-CONSTRUCTED ISSUE	09.05.19	DJK
J	Ex.POWER POLE ON LEAKES ROAD TO BE REMOVED	24.01.15	LP
I	LEAKES ROAD/BRIDGEFIELD PARKWAY KERB RETURNS	23.08.18	LP
H	CONSTRUCTION ISSUE	02.02.18	LP

SYMBOL	DESCRIPTION
[Symbol]	DRAIN, PROPERTY INLET & PIT
[Symbol]	EX DRAIN & PIT
[Symbol]	HOUSE DRAIN
[Symbol]	SEWER AND MAINTENANCE HOLE
[Symbol]	EX SEWER AND MAINTENANCE HOLE
[Symbol]	WATER MAIN
[Symbol]	EX WATER MAIN, VALVE & HYDRANT
[Symbol]	GAS MAIN
[Symbol]	EX GAS MAIN, VALVE
[Symbol]	TELSTRA SERVICES & PITS
[Symbol]	EX TELSTRA SERVICES & PITS

SYMBOL	DESCRIPTION
[Symbol]	RECYCLED WATER
[Symbol]	EX RECYCLED WATER
[Symbol]	ELECTRICAL U.G. SERVICES
[Symbol]	EX ELECTRICAL U.G. SERVICES
[Symbol]	ELECTRICAL SERVICE & PIT
[Symbol]	EX ELECTRICAL SERVICE & PIT
[Symbol]	EX ELECTRICAL ASSETS
[Symbol]	EX ELECTRICAL OVERHEADS
[Symbol]	GAS & WATER CONDUITS
[Symbol]	TOP OF BATTER
[Symbol]	TOE OF BATTER

SYMBOL	DESCRIPTION
[Symbol]	F FINISHED SURFACE AFTER CUTTING OR FILLING
[Symbol]	F&B TOP OF PROPOSED BATTER
[Symbol]	P PROPOSED PAVEMENT OR FOOTPATH SURFACE
[Symbol]	IL EXISTING OR PROPOSED INVERT LEVEL OF PIPE OR OPEN DRAIN
[Symbol]	TP TANGENT POINT
[Symbol]	CH CHAINAGE
[Symbol]	PSM DRAINAGE PIT No.
[Symbol]	EX FENCE
[Symbol]	EX WALL OR BUILDING

FIELD	VALUE
DRAWN BY	D.KONSTANDIS
DESIGNED BY	L.PHAN
CHECKED BY	R.HALFORD
AUTHORISED BY	S.RAVIDA
MELWAY	344.H110
DATUM	AHD

**REEDS CONSULTING**  
 LAND SURVEYING  
 CIVIL ENGINEERING  
 PLANNING  
 DEVELOPMENT CONSULTING

www.reedsconsulting.com.au  
 engineering@reedsconsulting.com.au

Lvl 4, 440 Elizabeth Street Melbourne Victoria 3000  
 p (03) 8660 3000

CITY OF MELTON  
 BRIDGEFIELD ESTATE, ROCKBANK  
 STAGE 1  
 LAYOUT PLAN - 1

DRAWING No.	1R2	VERSION	K
REFERENCE	22236E/1		
SHEET	2 OF 33		

**LEGEND**

- B2 600 B2 TYPE KERB AS PER EDM 301
- ES 150x150mm CONC. EDGE STRIP WITH SUBSOIL DRAINS UNDER.
- TEMPORARY TURNING AREA INCLUDING BOLLARDS AND "NO ROAD" SIGN.
- PROPOSED RAISED PAVEMENT.
- PROPOSED GAS & WATER/RECYCLED WATER CONDUITS
- PROPOSED ELECT. & TELCOMM. CONDUITS
- EXISTING SURFACE CONTOURS (0.25m INT.)
- DIRECTION OF LOT FINISHED SURFACE FALL / OVERLAND FLOW PATH
- 3.0m BIKE PATH 3.0m BIKE PATH. REFER TO EDM 401 FOR DETAILS.
- ULTIMATE WATERWAY CHANNEL. (SHAPING ARE SHOWN AS INDICATIVE ONLY)

**NOTES**

- DESIGN LINE IS NOT IN CENTRE OF ROAD
- RESERVE REFER TO CROSS SECTION FOR DETAILS.
- REFER TO SHEET 1 FOR TBM DATA
- DRAINAGE CO-ORDINATES SHOWN REFER TO CENTRE OF PIT/PIPE

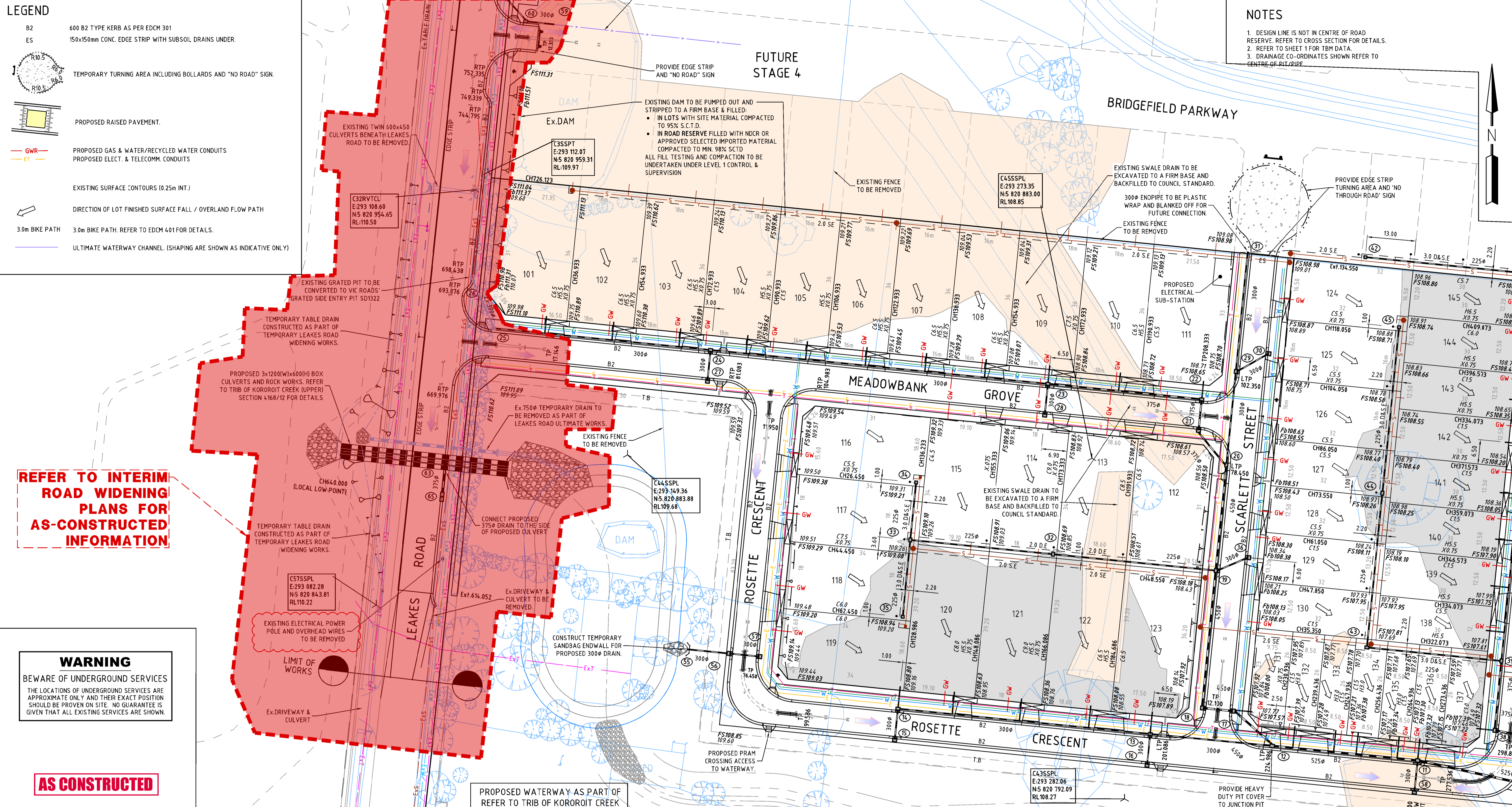

**REFER TO INTERIM ROAD WIDENING PLANS FOR AS-CONSTRUCTED INFORMATION**

**WARNING**  
BEWARE OF UNDERGROUND SERVICES  
THE LOCATIONS OF UNDERGROUND SERVICES ARE APPROXIMATE ONLY AND THEIR EXACT POSITION SHOULD BE PROVEN ON SITE. NO GUARANTEE IS GIVEN THAT ALL EXISTING SERVICES ARE SHOWN.

**AS CONSTRUCTED**

**DISCLAIMER**  
THE CONTENT ON THIS PLAN IS FOR PRELIMINARY PURPOSES ONLY AND IS SUBJECT TO THE FORMAL PLANNING APPROVAL BY CITY OF MELTON, DETAILED ENGINEERING DESIGN AND APPROVALS FROM CITY OF MELTON AND ALL SERVICE AUTHORITIES. AS SUCH THIS PLAN IS SUBJECT TO CHANGE WITHOUT NOTICE. THIS PLAN IS NOT TO BE USED FOR ANY PURPOSE OTHER THAN FOR PRELIMINARY PURPOSES. HOUSE SITING SHOULD ONLY BE COMPLETED ONCE COUNCIL APPROVED PLANS ARE ISSUED. THE DEVELOPER BEARS NO RESPONSIBILITY FOR ANY OF THESE CHANGES. THE PURCHASER SHOULD ASCERTAIN THE DETAILS ARE CORRECT BEFORE PROCEEDING.

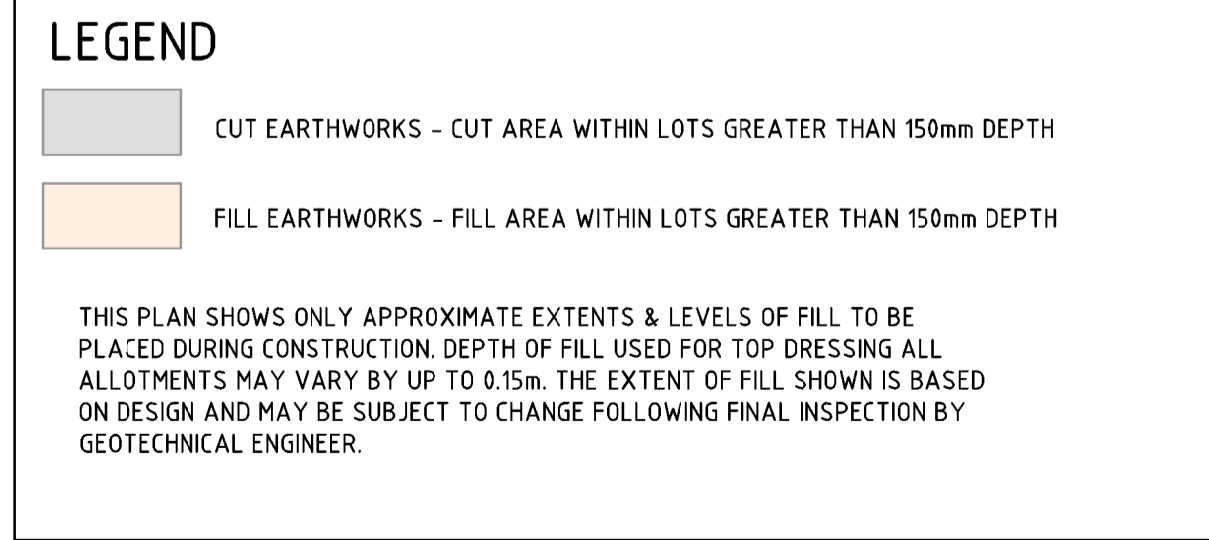
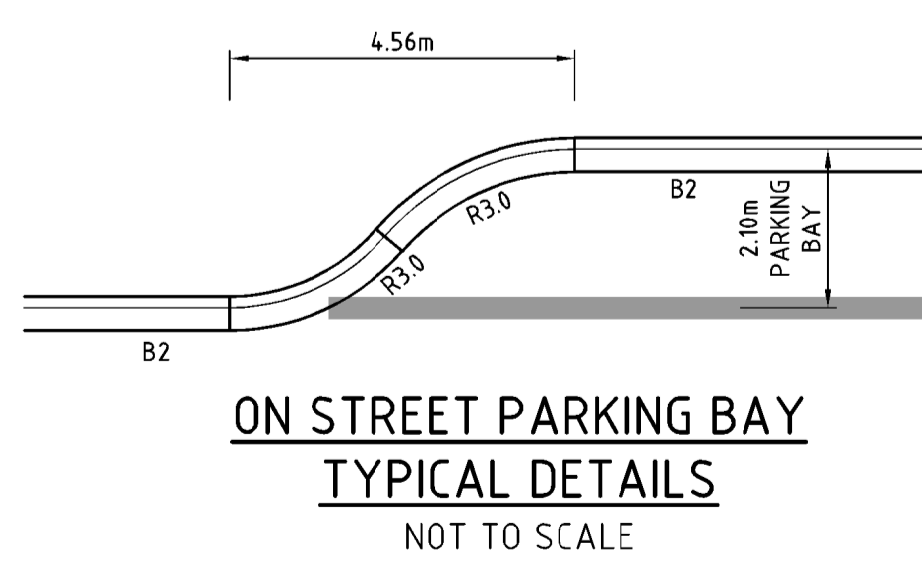
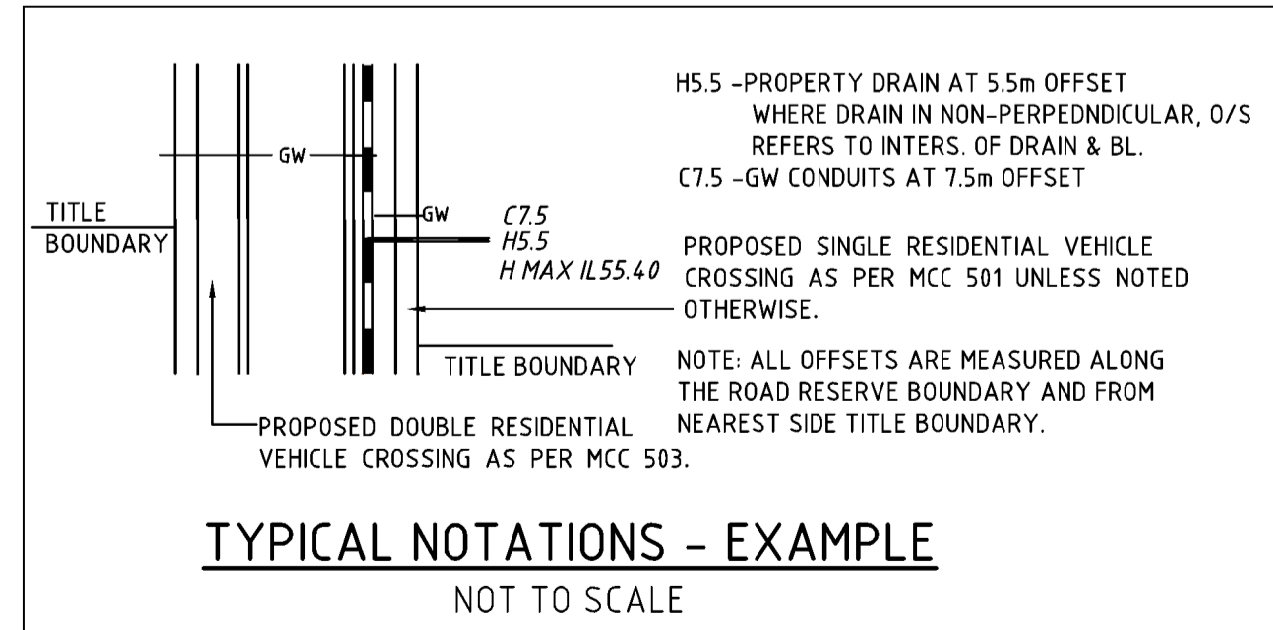

THIS DRAWING IS NOT TO BE COPIED OR SCALED

VERSION	REMARKS	DATE	BY
K	AS-CONSTRUCTED ISSUE	09.05.19	DJK
J	EX.POWER POLE ON LEAKES ROAD TO BE REMOVED	24.01.15	LP
I	MW WORKS REMOVED FROM DRAWING AND REFERENCED	23.08.18	LP
H	CONSTRUCTION ISSUE	02.02.18	LP

**LEGEND**

—	DRAIN, PROPERTY INLET & PIT	—	RECYCLED WATER
—	EX DRAIN & PIT	—	EX RECYCLED WATER
—	HOUSE DRAIN	—	ELECTRICAL U.G. SERVICES
—	SEWER AND MAINTENANCE HOLE	—	EX ELECTRICAL U.G. SERVICES
—	EX SEWER AND MAINTENANCE HOLE	—	ELECTRICAL SERVICE & PIT
—	WATER MAIN	—	EX ELECTRICAL ASSETS
—	EX WATER MAIN, VALVE & HYDRANT	—	EX ELECTRICAL OVERHEADS
—	GAS MAIN	—	GAS & WATER CONDUITS
—	EX GAS MAIN, VALVE	—	TOP OF BATTER
—	TELSTRA SERVICES & PITS	—	TOE OF BATTER
—	EX TELSTRA SERVICES & PITS	—	

SYMBOL	DESCRIPTION
F	FINISHED SURFACE AFTER CUTTING OR FILLING
FP	TOP OF PROPOSED BATTER
P	PROPOSED PAVEMENT OR FOOTPATH SURFACE
IL	EXISTING OR PROPOSED INVERT LEVEL OF PIPE OR OPEN DRAIN
TP	TANGENT POINT
CH	CHAINAGE
PSM	PROPOSED SIGN
—	DRAINAGE PIT No. TBM
—	EX FENCE
—	EX WALL OR BUILDING

**REEDS CONSULTING**

LAND SURVEYING  
CIVIL ENGINEERING  
PLANNING  
DEVELOPMENT CONSULTING

www.reedsconsulting.com.au  
engineering@reedsconsulting.com.au

Lvl 6, 440 Elizabeth Street Melbourne Victoria 3000  
p (03) 8660 3000

CITY OF MELTON  
BRIDGEFIELD ESTATE, ROCKBANK  
STAGE 1  
LAYOUT PLAN - 2

DRAWING No. 1R3  
VERSION K  
REFERENCE 22236E/1  
SHEET 3 OF 33

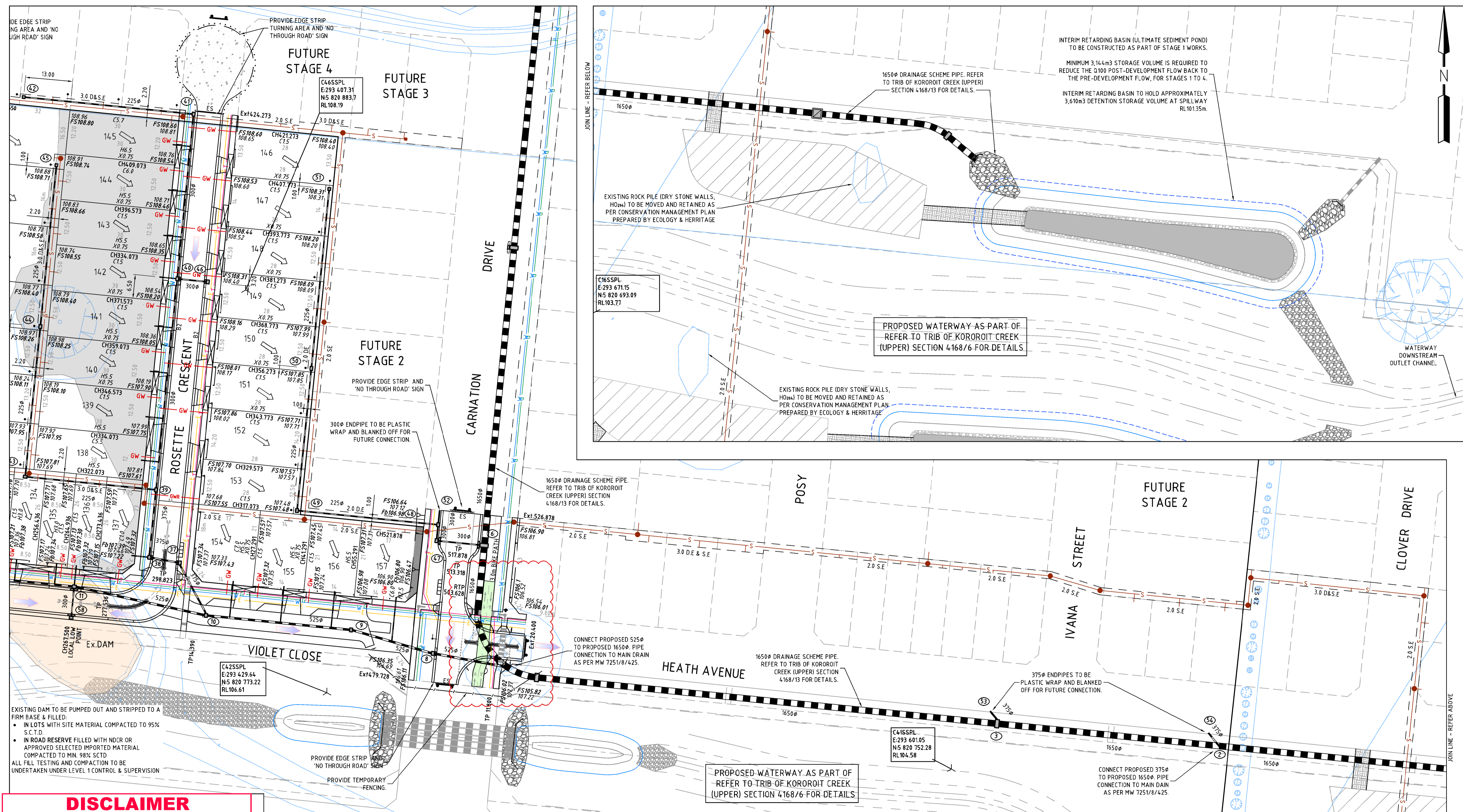

**DISCLAIMER**

THE CONTENT ON THIS PLAN IS FOR PRELIMINARY PURPOSES ONLY AND IS SUBJECT TO THE FORMAL PLANNING APPROVAL BY CITY OF MELTON, DETAILED ENGINEERING DESIGN AND APPROVALS FROM CITY OF MELTON AND ALL SERVICE AUTHORITIES. AS SUCH THIS PLAN IS SUBJECT TO CHANGE WITHOUT NOTICE. THIS PLAN IS NOT TO BE USED FOR ANY PURPOSE OTHER THAN FOR PRELIMINARY PURPOSES. HOUSE SITING SHOULD ONLY BE COMPLETED ONCE COUNCIL APPROVED PLANS ARE ISSUED. THE DEVELOPER BEARS NO RESPONSIBILITY FOR ANY OF THESE CHANGES. THE PURCHASER SHOULD ASCERTAIN THE DETAILS ARE CORRECT BEFORE PROCEEDING.

- NOTES**
- DESIGN LINE IS NOT IN CENTRE OF ROAD RESERVE. REFER TO CROSS SECTION FOR DETAILS.
  - REFER TO SHEET 1 FOR TBM DATA.
  - DRAINAGE CO-ORDINATES SHOWN REFER TO CENTRE OF PIT/PIPE.

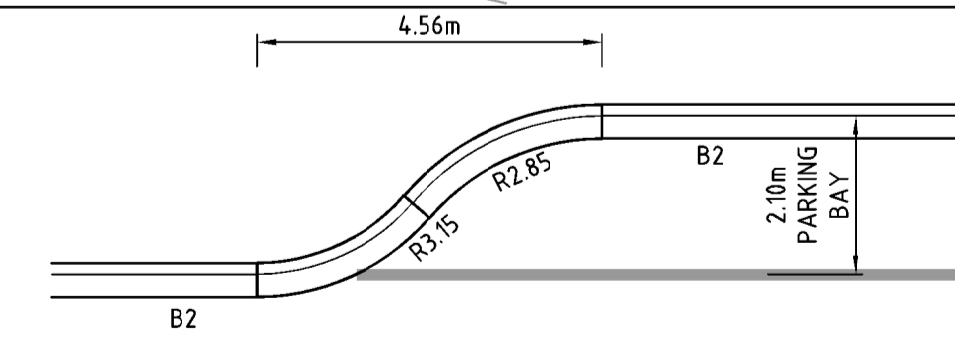

CARNATION DRIVE ON STREET PARKING BAY INDENT  
TYPICAL DETAILS  
NOT TO SCALE

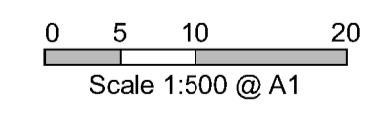

**WARNING**

BEWARE OF UNDERGROUND SERVICES

THE LOCATIONS OF UNDERGROUND SERVICES ARE APPROXIMATE ONLY AND THEIR EXACT POSITION SHOULD BE PROVEN ON SITE. NO GUARANTEE IS GIVEN THAT ALL EXISTING SERVICES ARE SHOWN.

**AS CONSTRUCTED**

THIS DRAWING IS NOT TO BE COPIED OR SCALED

VERSION	REMARKS	DATE	BY
L	AS-CONSTRUCTED	09.05.19	DJK
K	PAINTED BIKE PATH AT INTERSECTION	21.03.19	LP
J	PAINTED BIKE PATH AT INTERSECTION	20.03.19	LP
I	SEPERATING COUNCIL WORKS MW WORKS FROM	24.01.19	LP

LEGEND	
	RAIN, PROPERTY INLET & PIT
	SEWER AND MAINTENANCE HOLE
	EX SEWER AND MAINTENANCE HOLE
	WATER MAIN
	EX WATER MAIN, VALVE & HYDRANT
	GAS MAIN
	EX GAS MAIN, VALVE
	TELSTRA SERVICES & PITS
	EX TELSTRA SERVICES & PITS
	RECYCLED WATER
	EX RECYCLED WATER
	ELECTRICAL U.G. SERVICES
	EX ELECTRICAL U.G. SERVICES
	ELECTRICAL SERVICE & PIT
	EX ELECTRICAL ASSETS
	EX ELECTRICAL OVERHEADS
	GAS & WATER CONDUITS
	TOP OF BATTER
	TOE OF BATTER
	STREET SIGN
	DRAINAGE PIT No. TBM
	CHAINAGE
	PSM
	EX FENCE
	EX WALL OR BUILDING

DRAWN BY	DESIGNED BY	DESIGNED BY
D.KONSTANDIS	L.PHAN	L.PHAN
MELWAY	344.H110	CHECKED BY R.HALFORD
DATUM	AHD	AUTHORISED BY S.RAVIDA

**REEDS CONSULTING**

LAND SURVEYING  
CIVIL ENGINEERING  
PLANNING  
DEVELOPMENT CONSULTING

www.reedsconsulting.com.au  
engineering@reedsconsulting.com.au

Lvl 6, 440 Elizabeth Street Melbourne Victoria 3000  
p (03) 8660 3000

CITY OF MELTON  
BRIDGEFIELD ESTATE, ROCKBANK  
STAGE 1  
LAYOUT PLAN - 3

DRAWING No.	VERSION
1R4	L
REFERENCE	
22236E/1	
SHEET	4 OF 33